

ENDON®

Galina 12lt Pendant Light Fitting

INSTRUCTION MANUAL

Safety Warnings

- This product is only suitable for connection to a 240V~50Hz supply in accordance with current IEE wiring regulations, and should be installed in accordance with local Building Regulations. They are for domestic, indoor ceiling use only, and are **not** suitable for a Bathroom location.
- The light fitting should be connected to a lighting circuit protected by a 5 amp fuse (or a 6 amp miniature circuit breaker).
- Before installing your light fitting always switch off the mains supply, and remove the appropriate fuse or switch off the appropriate circuit breaker before commencing installation. Ensure that no one else has access that would enable the supply to be inadvertently reconnected.
- **This is a Class 1 product and must be Earthed.** The terminal blocks are supplied according to requirements of the fitting.
- Never fit bulbs of a higher wattage than those specified on the label, as these may cause overheating and damage the fitting.
- This product is suitable for dimming when used with dimmable bulbs.
- If you are in any doubt about your competence please consult a qualified electrician.
- If any modification is made it will invalidate the warranty and may render the product unsafe.

Care Information

Allow 10 minutes to cool before replacing, adjusting or cleaning.

Clean with a dry cloth only. Do not use liquid or abrasive cleaners on this product.

Assembly/ User Instructions

Before you start

Please read these instructions carefully before fitting and retain for reference.

Check the packaging and make sure that you have all the required parts. Follow each assembly step in order to prevent incorrect assembly. Ensure that the product is fully assembled as illustrated before use.

The Light pack contains:

Light fitting.

Fixing pack.

145 x Crystal lengths

The following tools may be required:

Selection of cross and flat head screwdrivers.

Electric drill and assorted drill bits.

Wire strippers.

These assembly diagrams overleaf are intended as a guide – if in doubt consult a qualified electrician.

1. Decide on the position of the light fitting / or remove existing light fitting. Take a note of the position of the electrical connections. Ensure there is a solid mounting surface, preferably a wooden joist or joist bridge to support the weight of the light fitting. **This product is heavy. We recommend a minimum of 2 people are need to ensure safe installation of this product.**
2. If you want to reduce the overall length of the fitting, this will be easier to complete before attaching the product to the ceiling. To reduce the drop of this pendant, push the steel cable up into the ceiling cover. To increase the drop press button X. To reduce the length of the electrical flex, pull the flex through the cable grip Y in the ceiling cover. Always ensure the weight of the product is supported by the steel cable and not the electrical flex.
3. Loosen the finials (A) and remove the fixing bracket (B) from the fitting. Using the screws and wall plugs (C) supplied in the fixing pack, secure the fixing strap to the ceiling, taking care to avoid damaging any concealed wiring.

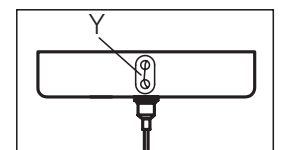
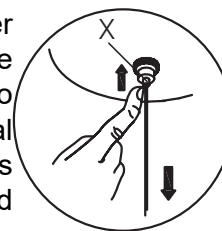

Assembly/ User Instructions Continued

- Support your fitting and connect the house wiring to the terminal blocks (D) – see expanded wiring details below. **NOTE: This is a Class I product and must be earthed.**
- Secure the product to the fixing bracket (B) by locating the fixing bolts (E) through the holes in the ceiling cover and refitting the finials (A) set aside earlier.
- Fit the bulbs (F) - not supplied). **NOTE: Never fit bulbs of a higher wattage than those specified on the label, as these may cause overheating and damage the fitting.**
- Hook the crystal lengths (G) inside of the shade
- Turn on the power and test.

